

evolution xpress curved

user instructions



①



②

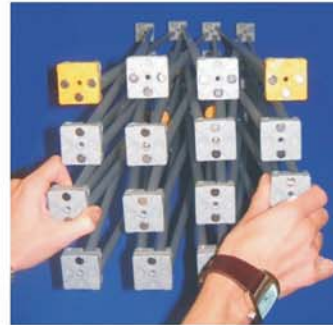

③

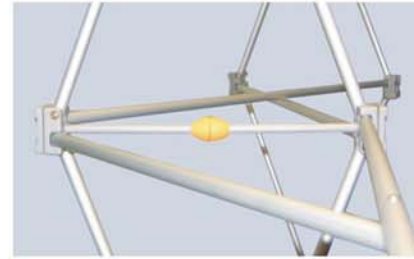

④

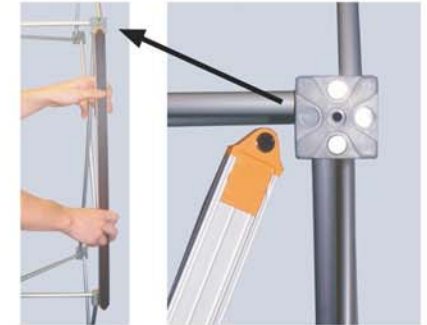

A typical 3 x 3 kit may include:
1 Elipse transit case,
1 popup frame, 18 magnetic bars
and 5 flexible panels
(3 front curve and 2 'D' end)

Lay the popup frame on the floor. The two saffron nodes should be at the top and facing you

Lift the top of the popup frame to expand the structure

Ensure all of the popup frame magnetic arms are locked into position

Connect the magnetic bars to the popup frame nodes

⑤



⑥

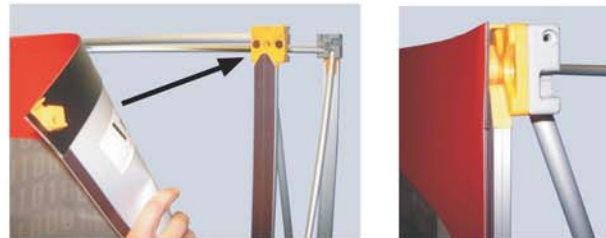

Panel fitting sequence



The magnetic bars should run vertically (3 in a line) 4 lines on the front and 1 line on either side at the back of the popup frame

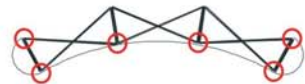

Position bars in vertical strips at the 6 points of the frame marked ○

Unroll each flexible panel; attaching the front panels first
Locate the magnetic saffron hanger hook onto each of the saffron nodes
(The 3 panels with the rigid strip at their base fit to the front of the popup)

In order to position the panels correctly, once hooked at the top, line up the panel edges half way across the magnetic bars

Once fitted the panels may need slight adjustment to line up perfectly

To dismantle the system reverse the instructions remembering to:

- Peel each panel from the bottom edge and roll with the magnetic tape on the inner side of the panel
- Remove all magnetic bars and unfasten all magnetic arms before collapsing the popup frame
- Place each rolled panel into the case individually, one inside the previous

Technical Specification (3 x 3 curved)

- Overall assembled size : 2235mm (H) x 2540mm (W) x 685mm (D)
- Typical kit weight (including transit case) : 23.50kg approx.
- Single magbar weight : 0.2kg approx.
- Single 3 x 3 popup frame weight : 4.45kg approx.

Notes

- 1, For graphic panel dimensions please refer to separate data sheet UI046
- 2, For light fitting instructions please refer to separate instruction sheet UI036